

# AXIS 6000

## SPECIFICATIONS



1300 122 868



sales@axislifts.com.au

### TECHNICAL DATA

DRIVE SYSTEM	PATENTED SCREWNUT SYSTEM
RATED LOAD	250KGS - 410 OR 500KGS (DEPENDING ON PLATFORM SIZE)
POWER SUPPLY	1-PHASE 230V 50 Hz/9 A/16 A SLOW 3-PHASE 230V 50 Hz/9 A/16 A SLOW 3-PHASE 400V 50 Hz/5.2 A/16 A SLOW
CONTROL VOLTAGE	24V
NUMBER OF STOPS	MAX 6 STOPS PER LIFT
NUMBER OF DOORS	MAX 6 DOORS PER LIFT 2 DOORS PER FLOOR
TRAVEL SPEED	0.15m/s
MOTOR POWER	2,2KW
ENVIRONMENT	INDOOR
TRAVEL HEIGHT	MINIMUM 2240mm (1100 - 1600mm WITH HALF HEIGHT DOOR)
PIT	50mm (NO PIT IS REQUIRED WHEN THERE IS A THRESHOLD/RAMP)
PLATFORM CONTROL	HOLD TO RUN THE DESTINATION BUTTON MUST BE KEPT PRESSED DOWN DURING THE WHOLE RIDE
LANDING CONTROL (ON DOOR)	ONE TOUCH CALL
EMERGENCY LOWERING	EMERGENCY UPS WILL AUTOMATICALLY LOWER LIFT IN THE EVENT OF POWER FAILURE

PLEASE CONTACT OUR FRIENDLY SALES TEAM FOR MORE DETAILS

# AXIS 6000

## SPECIFICATIONS



1300 122 868



sales@axislifts.com.au

### DRAWINGS

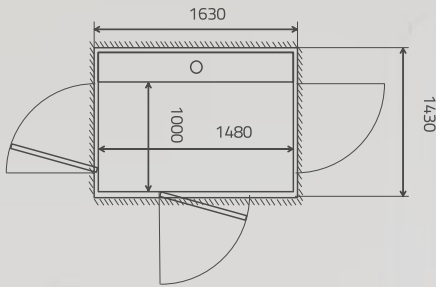

**Size: 1000 x 1480 mm**  
Rated load:  
410 kg / 5 persons

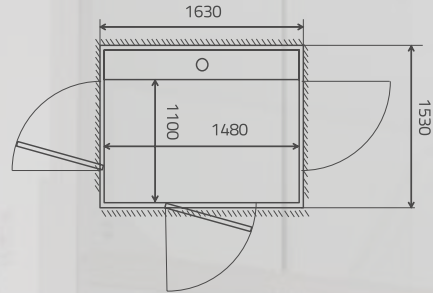

**Size: 1100 x 1480 mm**  
Rated load:  
410 kg / 5 persons

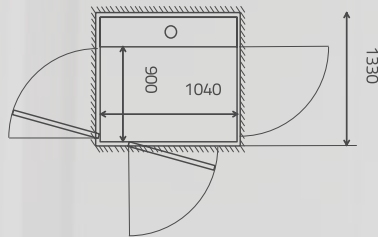

**Size: 900 x 1040 mm**  
Rated load:  
250 kg / 2 persons

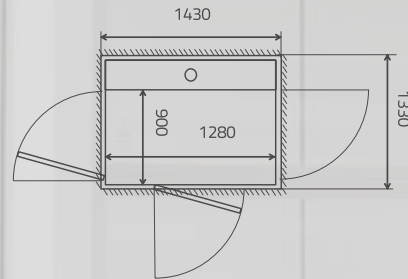

**Size: 900 x 1280 mm**  
Rated load:  
410 kg / 5 persons

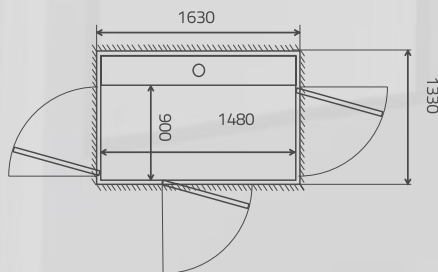

**Size: 900 x 1480 mm**  
Rated load:  
410 kg / 5 persons

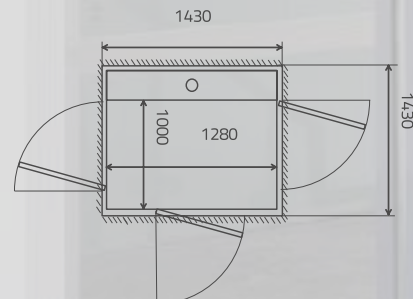

**Size: 1000 x 1280 mm**  
Rated load:  
410 kg / 5 persons

PLEASE CONTACT OUR FRIENDLY SALES TEAM FOR MORE DETAILS